

DOPAK® Process Sampler Type DPJ

fixed volume configuration with cooling jacket

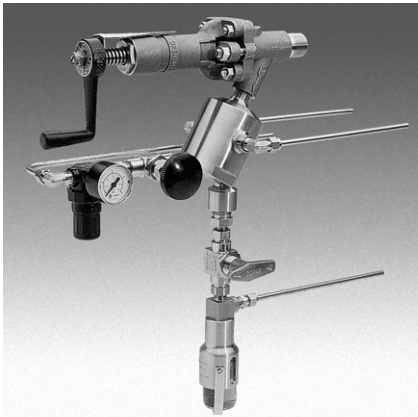

The ability to provide a jet purge adapter to a piston type sampling valve ensures optimal retrieval of a representative, contamination free sample. The DPJ type sampler in fixed volume configuration with cooling jacket allows purging of the sample outlet of the valve to eliminate dead volume in addition to a fixed sample volume at the required temperature. A separate cooler is not necessary. The jet purge adapter has two flow paths. The first flow path allows the product to flow into the sample bottle and the second flow path enables the jet purge adapter to be purged with an inert gas.

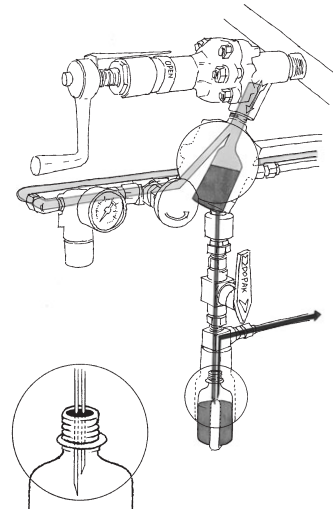

1 OPERATION/FUNCTION

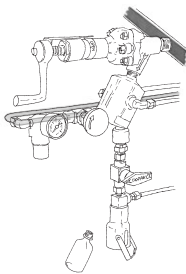

0 - off
Provide a new septum on your sample bottle. Insert the bottle, with cap and septum into the sleeve until the septum is pierced by the needles. Put the bottle retaining clip in place.

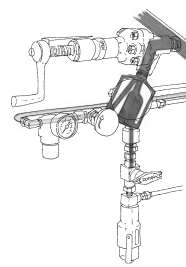

1 - process
Open the piston valve allowing the product to flow into the sample chamber. The fixed volume chamber determines the amount of sample. Close the piston valve.

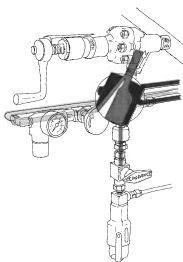

2 - cooling
Allow coolant to flow through the jacket. Keep this position for the required time in order to cool the liquid down to the required temperature.

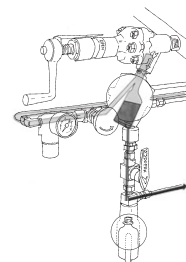

3 - sample
Open the purge valve and the block valve between needle assembly and jet purge adaptor. The inert gas will assist the sample to flow into the bottle and will purge the sampler. This position can be held for any required time.

2 TYPICAL P & ID

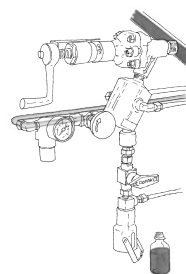
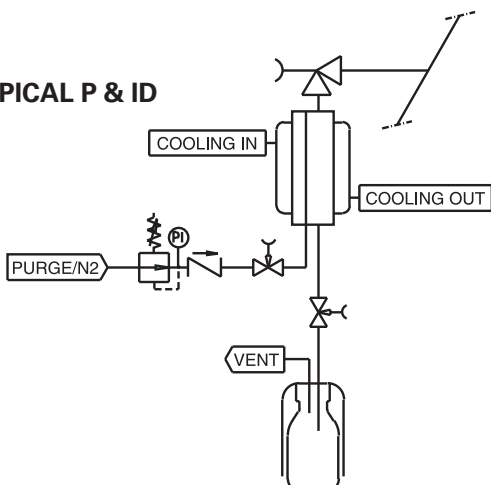

4 - off
Close the valves. Remove the bottle retaining clip and pull the bottle out from the sleeve. The septum reseals automatically. Put a new bottle in place.



3 FEATURES/ADVANTAGES/PROPERTIES

- | | |
|---|--|
| <input type="checkbox"/> Sampling independent of process conditions | <input type="checkbox"/> Closed sampling |
| <input type="checkbox"/> High pressure and vacuum applications | <input type="checkbox"/> Fixed volume sampling |
| <input type="checkbox"/> Representative sampling | <input type="checkbox"/> Purging of sampler |
| <input type="checkbox"/> Zero dead volume | |

4 BASIC SPECIFICATIONS

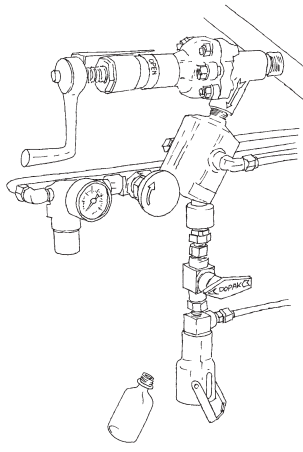
Material	SS316, SS316L.	
Sleeve Type	60cc sleeve with bottle retaining clip.	
Needle Assembly	Single piece VTO needle assembly with vent to outlet connection 1/4" FNPT. Process/vent needle ID:1.35 mm.	
Sample Chamber	50cc.	
Valve	Piston valve. PTFE seats. Pressure range ANSI B16.34. Temperature range -17/+232°C (-20/+450°F).	
Operation	Manual.	
Connections	Process: 3/4" MNPT Vent: 1/4" FNPT Purge: 1/4" FNPT, needle valve, regulator, gauge and check valve included.	

Please note: the above is a basic specification only. DOPAK® Samplers can be offered with a wide variety of options as mentioned below.

5 OPTIONS

- | | |
|---|--|
| <input type="checkbox"/> Temperature indicator | <input type="checkbox"/> Block valve |
| <input type="checkbox"/> Solvent purge facility | <input type="checkbox"/> Enclosure |
| <input type="checkbox"/> Lockable handle | <input type="checkbox"/> Mounting bracket |
| <input type="checkbox"/> Mounting plate | <input type="checkbox"/> Steam sterilising cap |
| <input type="checkbox"/> Pipe stand | <input type="checkbox"/> Exotic materials |

For more information please refer to our sheets:

Options for DOPAK® process sampler type DPJ. Components for DOPAK® process samplers.

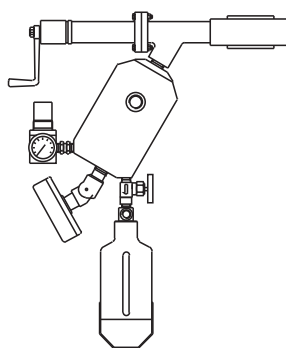
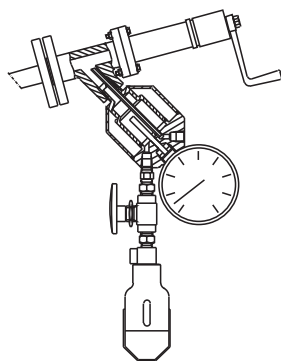

Dopak Inc.
Houston, Texas 77041, USA
Phone 713-460-8311
Fax 713-460-8578
E-mail info@dopak.com

Dovianus BV
Bergschenhoek, The Netherlands
Phone +31 10 524 20 00
Fax +31 10 456 67 74
E-mail info@dopak.nl

Your local representative: